

"A" DISCHARGE HEIGHT RANGE (IN 3" ADJUSTABLE INCREMENTS)				
	9 FT. DUMPER	10 FT. DUMPER	11 FT. DUMPER	12 FT. DUMPER
400 LB. CART	66-5/8" TO 84-5/8"	78-5/8" TO 96-5/8"	90-5/8" TO 108-5/8"	102-5/8" TO 120-5/8"
600 LB. CART	59-5/8" TO 77-5/8"	71-5/8" TO 89-5/8"	83-5/8" TO 101-5/8"	95-5/8" TO 113-5/8"

"B" REACH OUT	
400 LB. CART	6"
600 LB. CART	13"

NOTE: DIMENSIONS ARE APPROXIMATE DUE TO VARYING CART SIZES.

	9 FT. DUMPER	10 FT. DUMPER	11 FT. DUMPER	12 FT. DUMPER
"C" MAX OPERATING HEIGHT	120-1/2"	132-1/2"	144-1/2"	156-1/2"
"D" COLUMN HEIGHT	108-3/4"	120-3/4"	132-3/4"	144-3/4"
"E" OVERALL HEIGHT	111"	123"	135"	147"

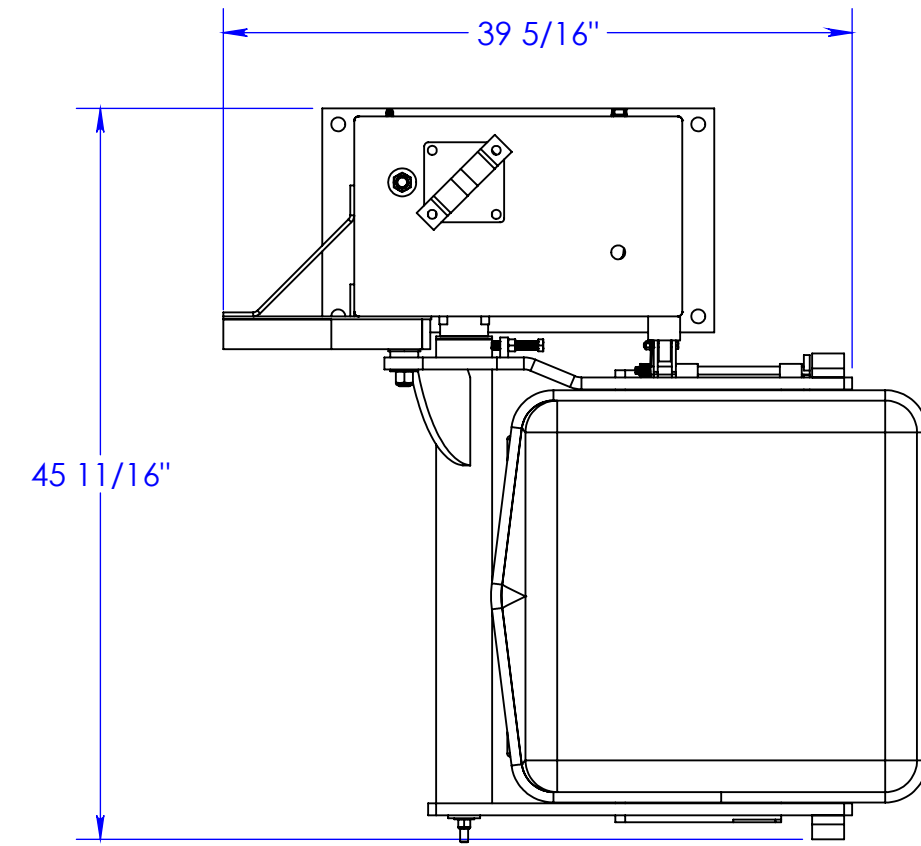

SHOWN WITH OPTIONAL DRUM ATTACHMENT

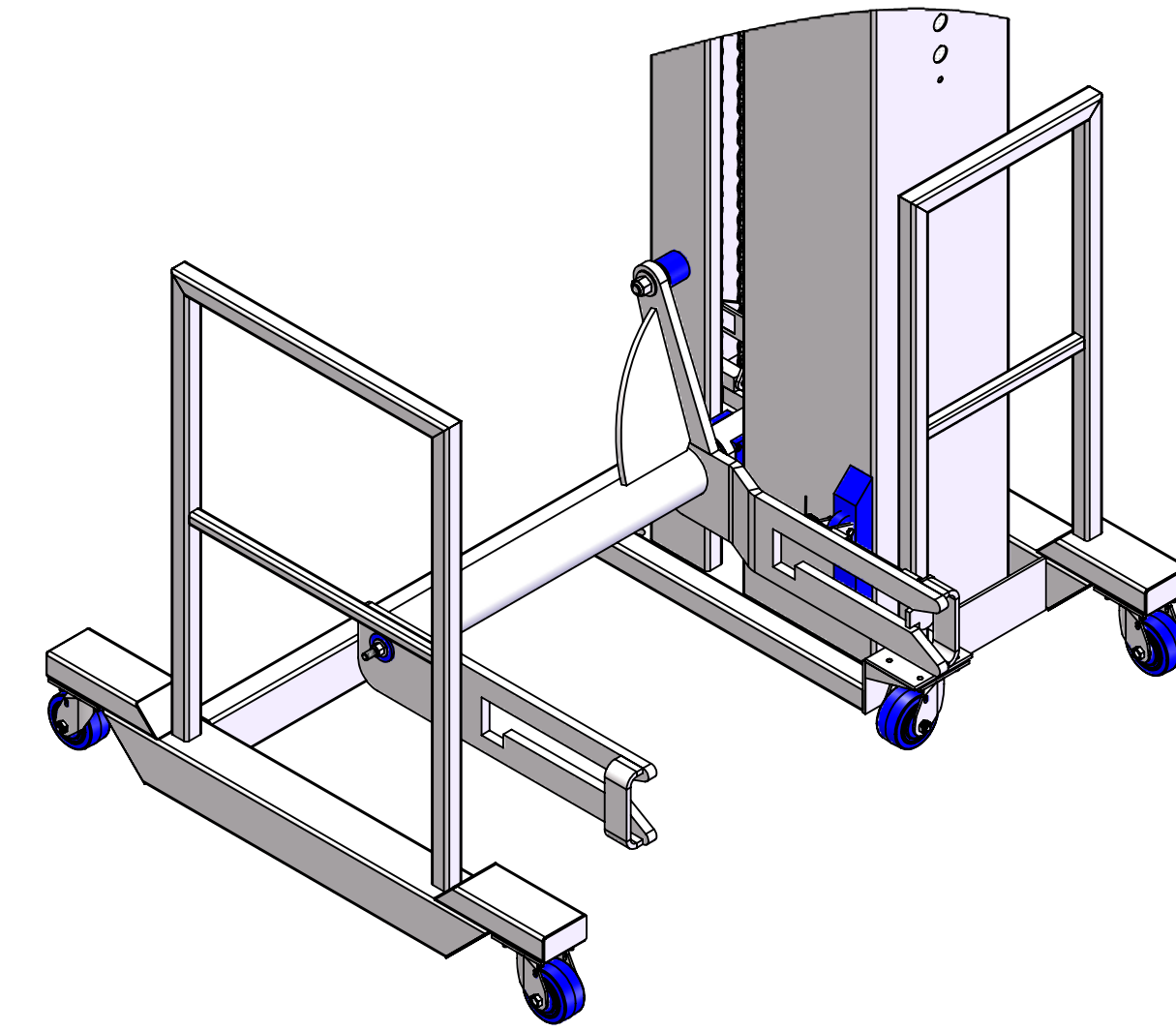
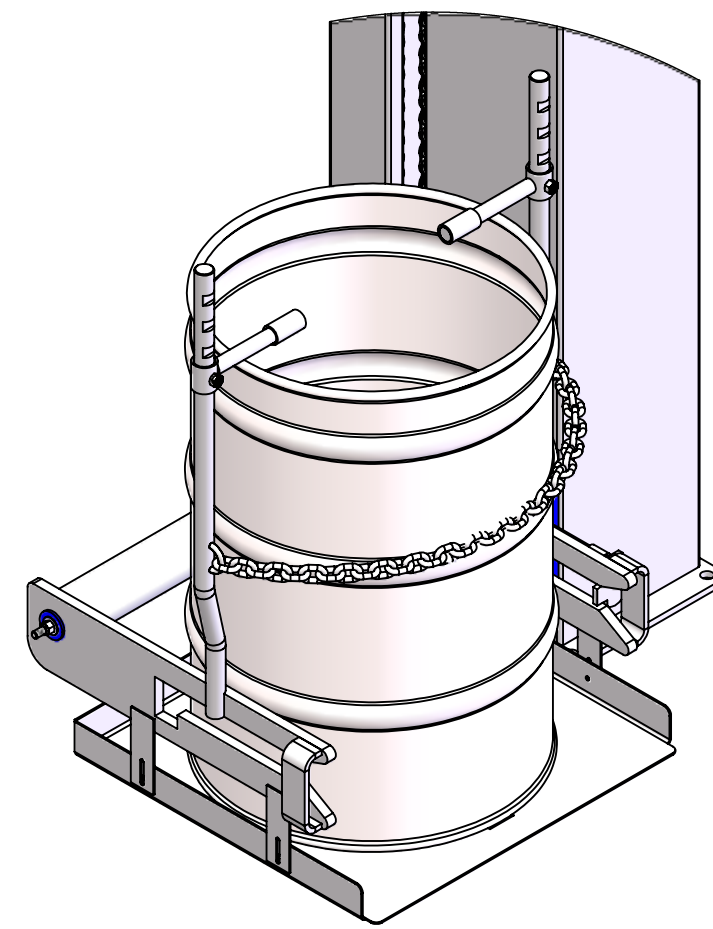

SHOWN WITH OPTIONAL PORTABLE CADDY ATTACHMENT

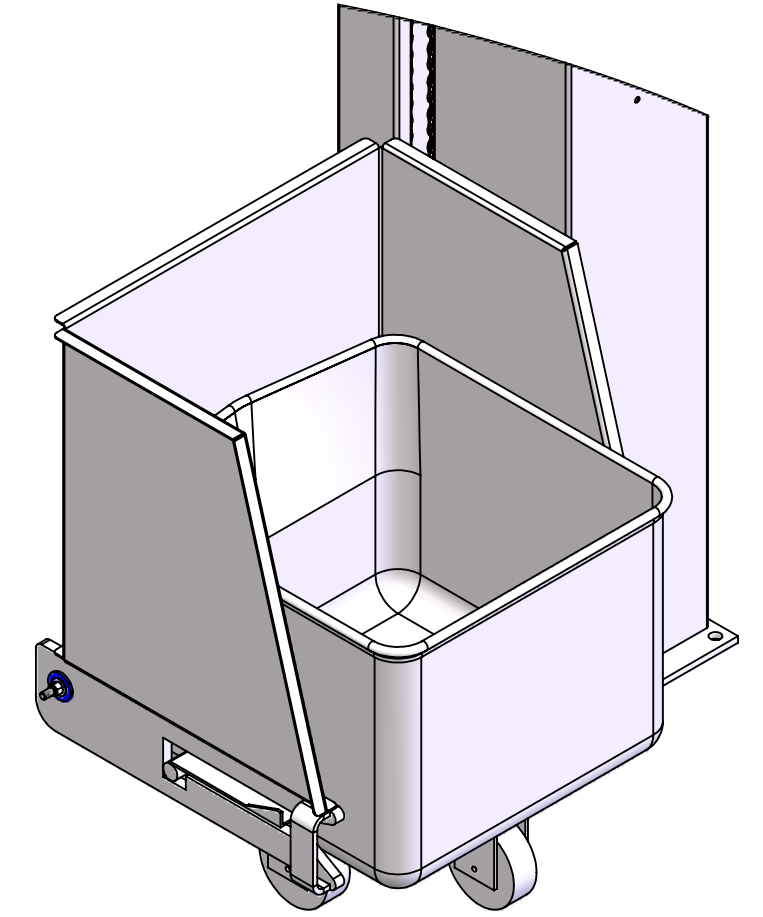

SHOWN WITH OPTIONAL CHUTE ATTACHMENT

NOTE: ADD 1-7/8" TO ALL HEIGHT DIMENSIONS WHEN USING PORTABLE CADDY ATTACHMENT

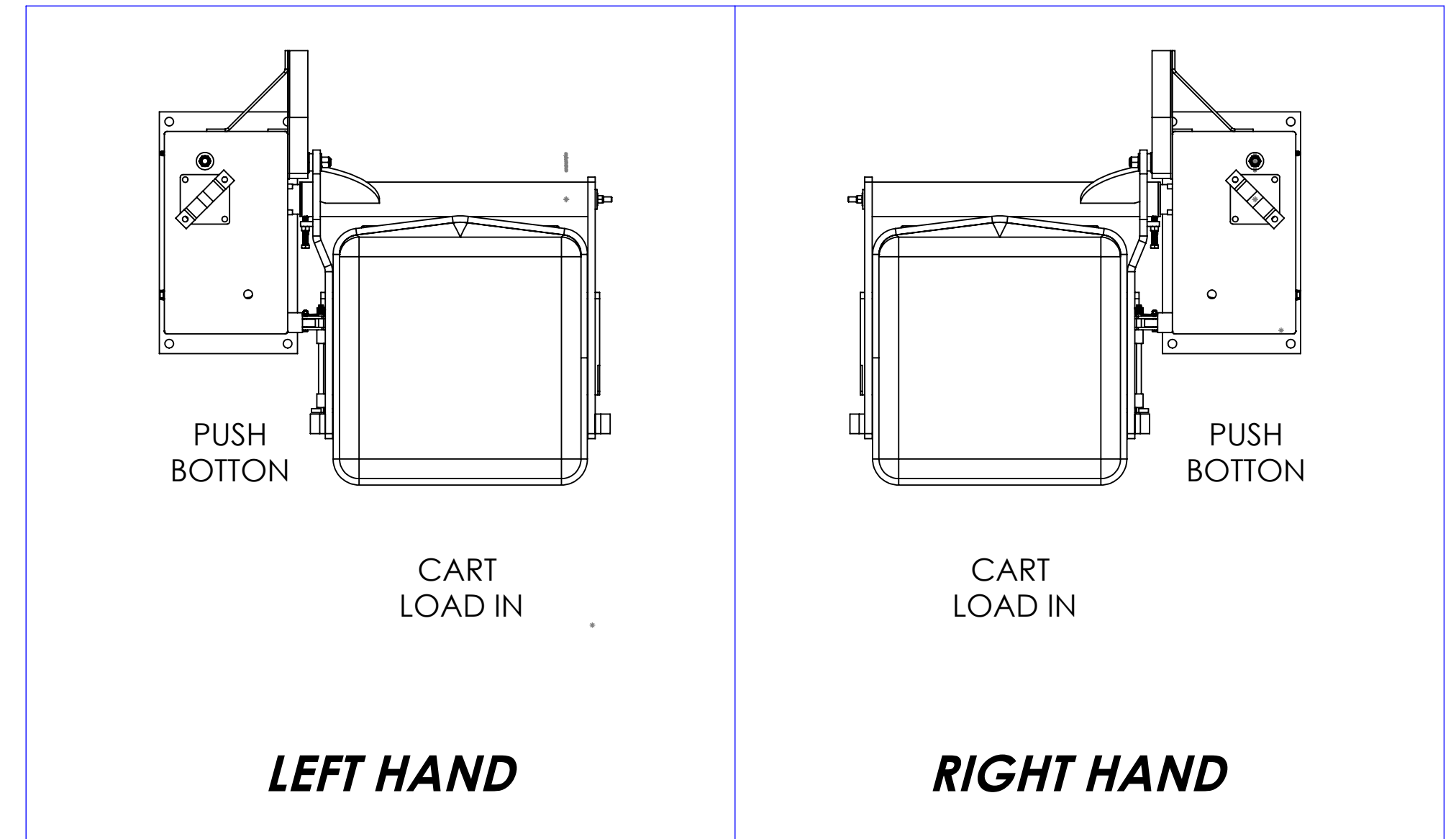
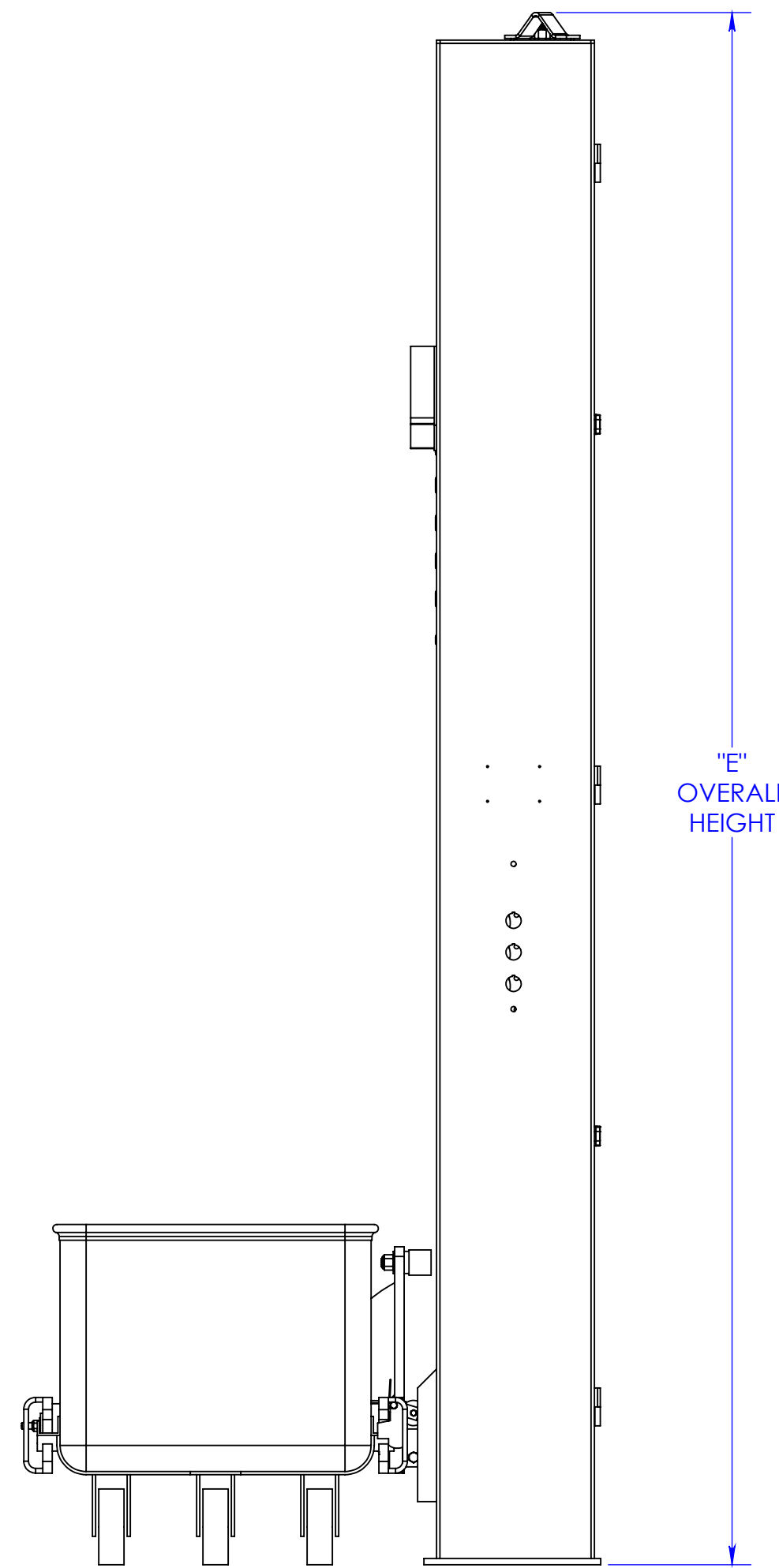
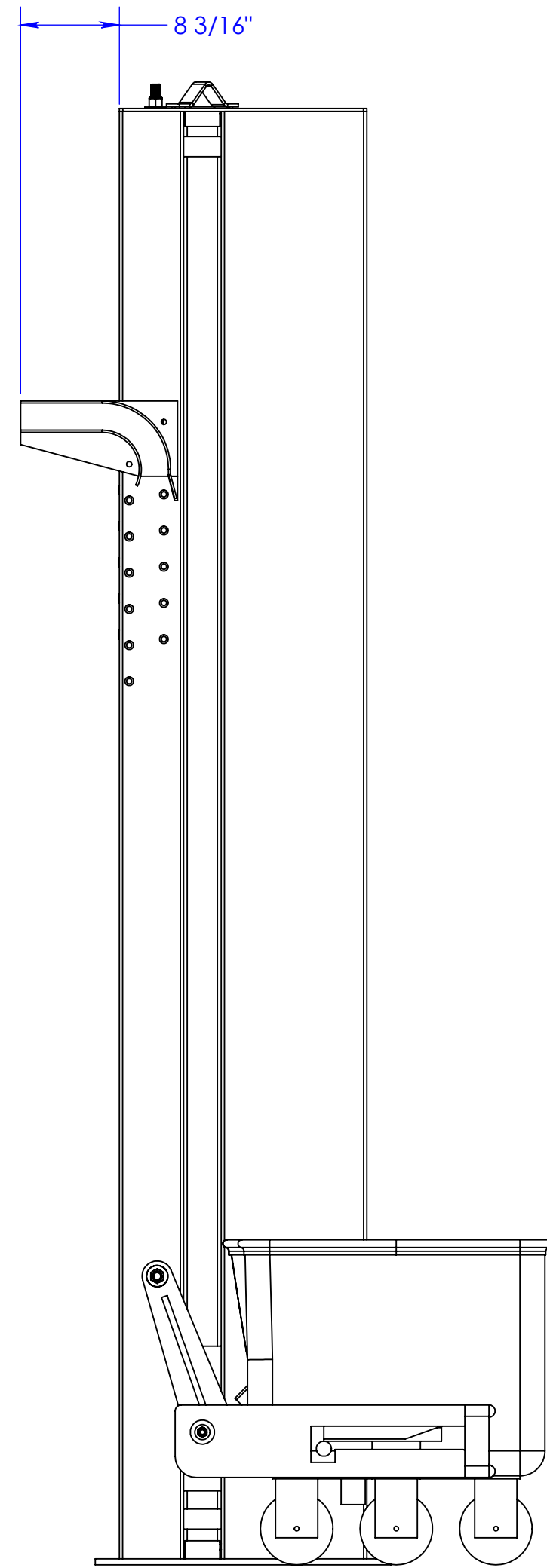
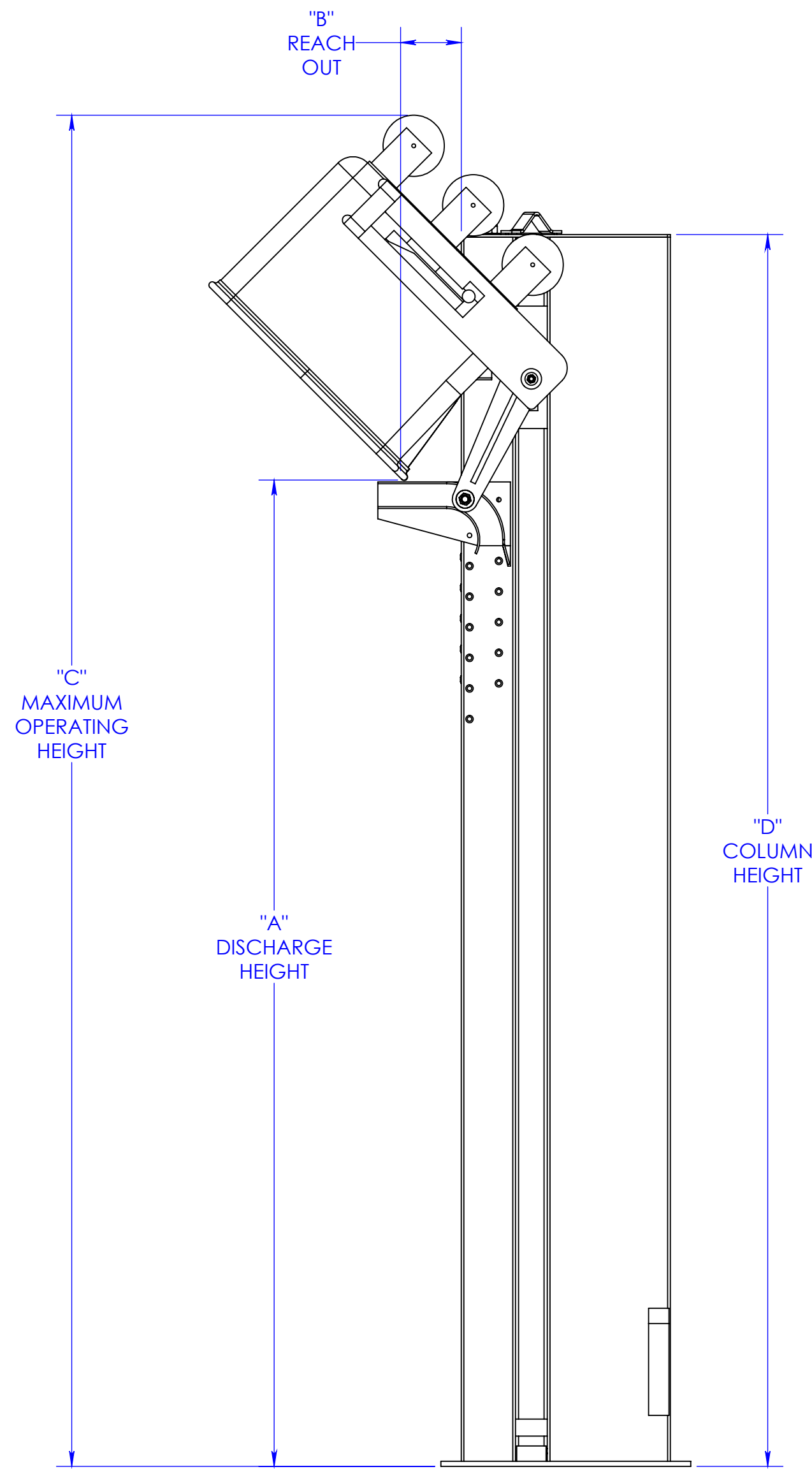

FEATURES

- FLOOR LEVEL LOADING
- ADJUSTABLE DISCHARGE HEIGHT (3" INCREMENTS)
- ADJUSTABLE DISCHARGE ANGLE (UP TO 45°)
- RIGHT AND LEFT HAND MODELS
- POSITIVE CHAIN DRIVE
- MECHANICAL BRAKE
- EASY INTERNAL COMPONENT ACCESS
- STAINLESS STEEL EXTERNAL CONSTRUCTION

Customer:		Project:	
---		SALES DRAWING	
Drawing Name:		Drawing Description:	
---		POST DUMPER	
Job No.:	Drawn By:	Created Date:	Required By:
---	PDS	03/12/18	ASAP
Sheet:		Scale:	Rev: Size
1 of 1		1:12	A D
File Location:		\W\SHARESPACE\1\Active\SHARE-	
PETER-POST DUMPER.			
UNLESS OTHERWISE SPECIFIED: DIMENSIONS ARE IN INCHES TOLERANCES: FRACTIONAL - ANGULAR: MACH - BEND - TWO PLACE DECIMAL - THREE PLACE DECIMAL -		PROPRIETARY AND CONFIDENTIAL THE INFORMATION CONTAINED IN THIS DRAWING IS THE SOLE PROPERTY OF E-EQUIP MFG. CO., INC. ANY REPRODUCTION IN PART OR AS A WHOLE WITHOUT THE WRITTEN PERMISSION OF E-EQUIP MFG. CO., INC. IS PROHIBITED.	
E-Quip Manufacturing Co., Inc. Custom Stainless Food Processing Equipment 230 Industry Avenue - Frankfort, IL 60423 Ph. (815)464-0053 - Fax (815) 464-0059			
PRINTED ON: 3/12/2018			